

SD14-H15-5.5



Application

Fastening of metal decks, liner trays onto metal beams

Fastener material

Carbon steel, Durocoat® 480

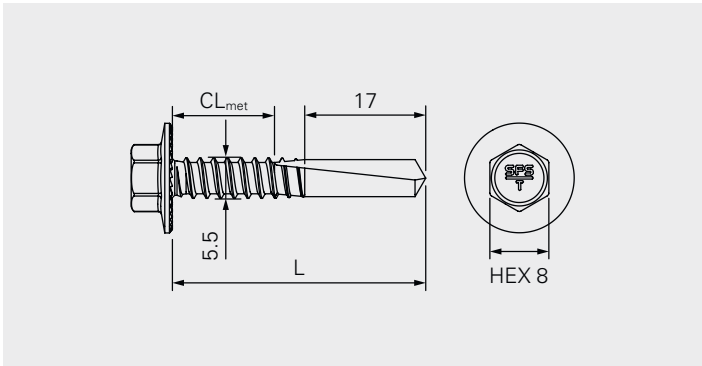

Component 1 (t _I)		Component 2 (t _{II})		$\Sigma_{\max} t_I + t_{II}$
Steel	0.50–1.50	Steel	4.0–12.0	13.50

Approvals



Features and Benefits

- Self drilling fastener suitable for installation of metal decks and liner trays
- Reduced risks of over driving and unwinding achieved by locking ribs
- High shear resistance achieved by optimized fastener geometry
- High corrosion durability thanks to special galvanic zinc coating

Documentation

Approval document (ETA) | Declaration of performance (DoP)

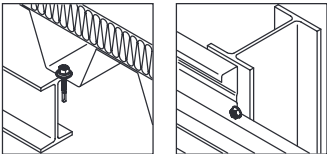

Fastener in carbon steel
onto steel

Product code	PU	L	CL _{met}	t _{fix, met}	
SD14-H15-5,5×34	500	34	0-23	0-11/19	1420173

t_{fix, met}: CL_{met, min.} - (CL_{met, max.} - t_{fl, max.} or load-bearing clamping length according ETA)/(CL_{met, max.} - t_{fl, min.})



Accessories/Ancillaries

Product code	PU	Drive	Head drive	
E308-¼"-50	1	¼"	HEX8	1646160
Drive shaft H15 head	5	¼"	H15	1517546